



# VILLAGE OF EAST HILLS

INCORPORATED JUNE 24, 1931

209 Harbor Hill Road, East Hills, New York 11576  
 Telephone (516) 621-5600 • Fax (516) 625-8736

## SAMPLE LOT COVERAGE CALCULATIONS

### Sample drawing for lot coverage calculations:

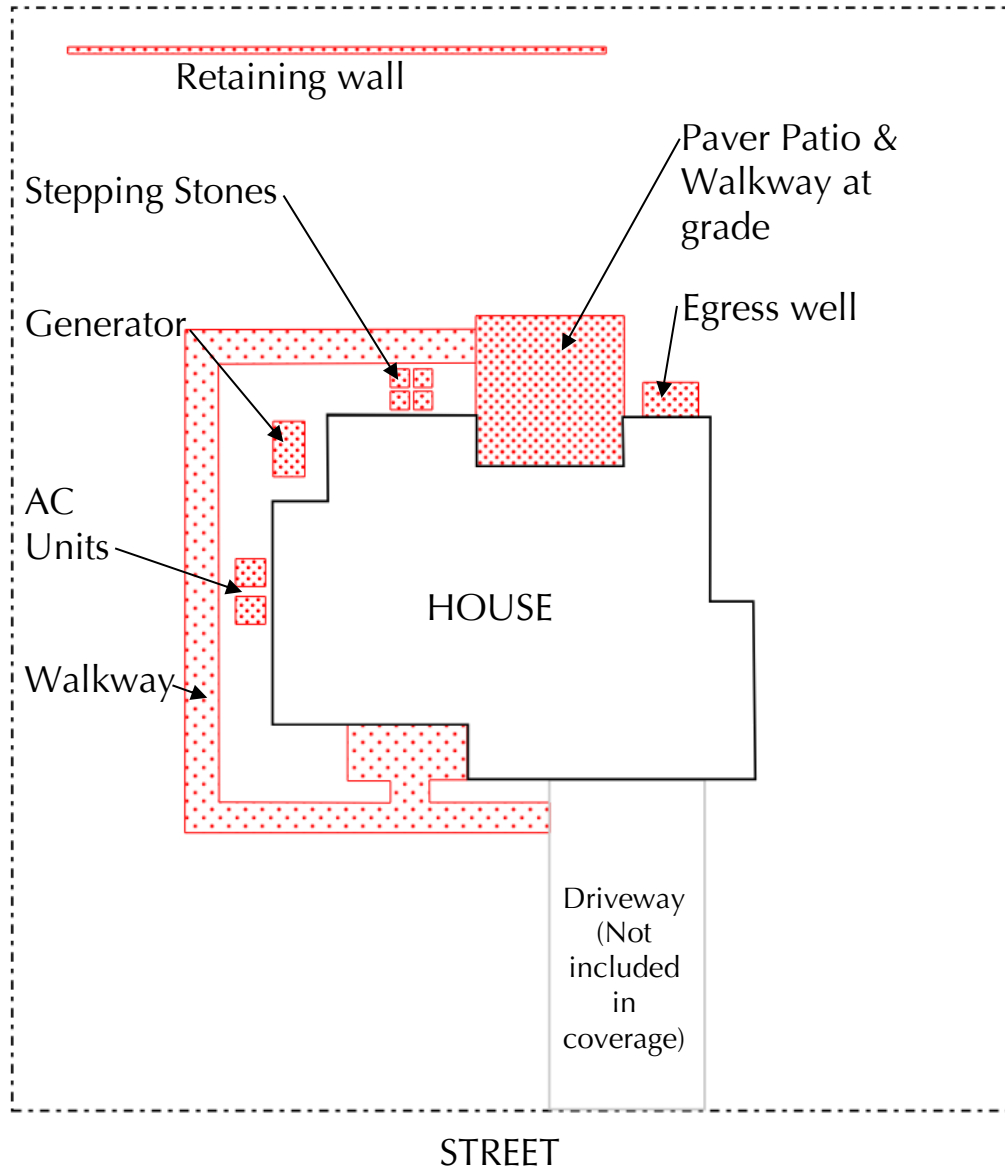

CALCULATIONS	
House	# sf
Paver Patio	# sf
Paver Walkways	# sf
Egress Well	# sf
Stepping Stones	# sf
Exist. Retaining Wall	# sf
Existing Generator	# sf
Existing AC units	# sf
<b>Total Lot Coverage</b>	<b># sf</b>

**NOTE:** If addition of impervious surface is equal to or greater than 200 SF, the project must include facilities (ie. Drywell) for on-site water retention and discharge of stormwater runoff from the added area. A drywell application shall also be submitted.

**Lot Area** # sf  
**Lot Coverage** # %