



VILLAGE OF EAST HILLS

INCORPORATED JUNE 24, 1931

209 Harbor Hill Road, East Hills, New York 11576
 Telephone (516) 621-5600 • Fax (516) 625-8736

SAMPLE

REAR YARD COVERAGE CALCULATIONS

Sample drawing for rear yard coverage calculations:

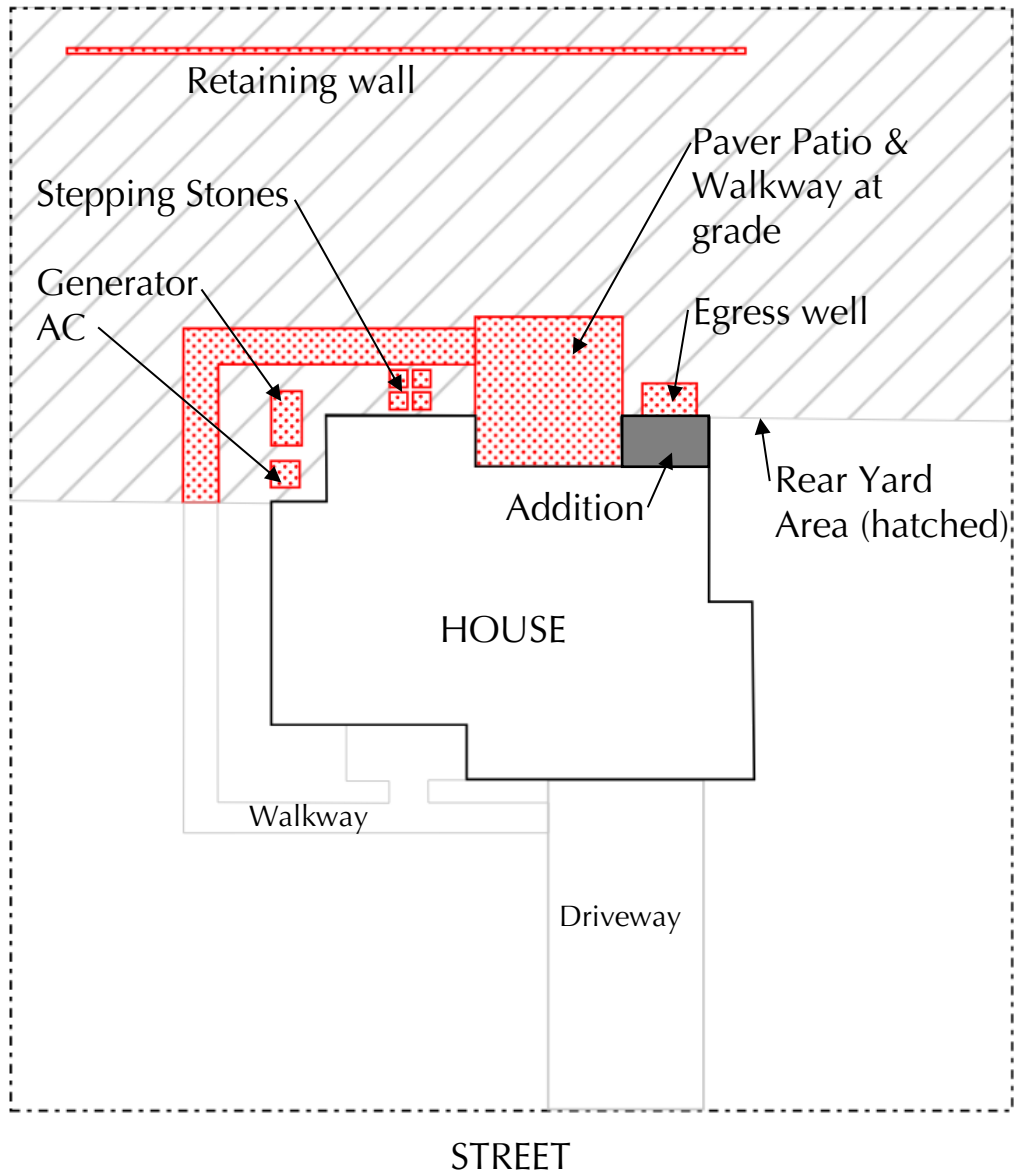

CALCULATIONS	
Paver Patio	# sf
Paver Walkway	# sf
Egress Well	# sf
Stepping Stones	# sf
Exist. Retaining Wall	# sf
Existing Generator	# sf
Existing AC unit	# sf
Total	# sf

NOTE: If addition of impervious surface is equal to or greater than 200 SF, the project must include facilities (ie. Drywell) for on-site water retention and discharge of stormwater runoff from the added area. A drywell application shall also be submitted.

Area of Rear Yard # sf
Rear Yard Coverage # %



VILLAGE OF EAST HILLS

INCORPORATED JUNE 24, 1931

209 Harbor Hill Road, East Hills, New York 11576
 Telephone (516) 621-5600 • Fax (516) 625-8736

SAMPLE

REAR YARD COVERAGE CALCULATIONS

Sample drawing for rear yard coverage calculations – Corner lot:

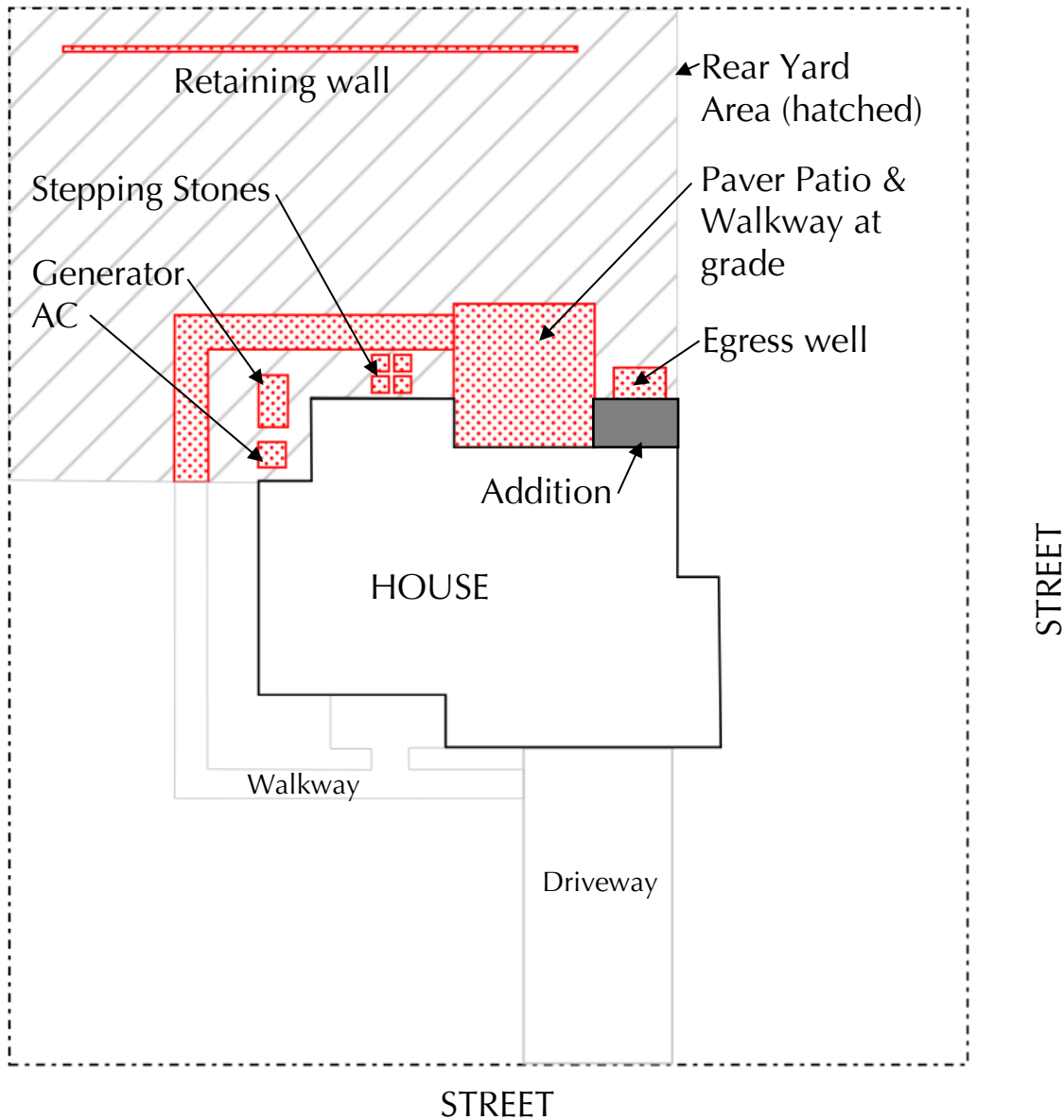

CALCULATIONS	
Paver Patio	# sf
Paver Walkway	# sf
Egress Well	# sf
Stepping Stones	# sf
Exist. Retaining Wall	# sf
Existing Generator	# sf
Existing AC unit	# sf
Total	# sf

NOTE: If addition of impervious surface is equal to or greater than 200 SF, the project must include facilities (ie. Drywell) for on-site water retention and discharge of stormwater runoff from the added area. A drywell application shall also be submitted.

Area of Rear Yard # sf
Rear Yard Coverage # %